

Product Outline Drawing

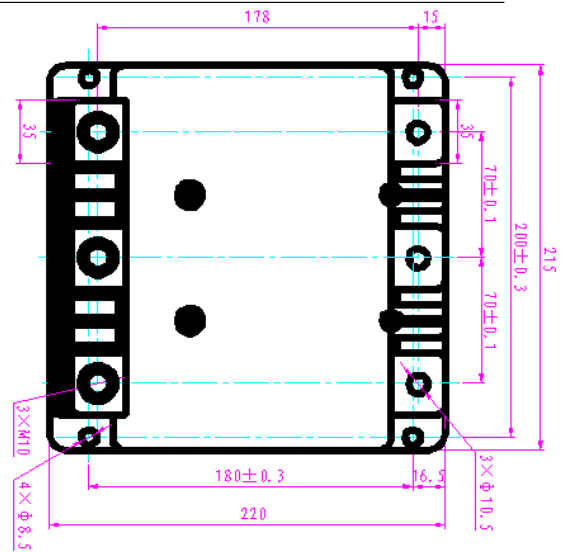

CKJ11-630/3.6 AC Vacuum Contactor

Technical Parameters		
Rated Voltage	kV	3.6
Rated Current	A	630
Rated Making Capacity	A/100 Times	6300
Rated Breaking Capacity	A/25 Times	5000
Limited Breaking Capacity	A/3 Times	6300
Rated Short Time Withstanding Current(2s)	kA	5
Rated Peak Withstanding Current	kA	12.5
Mechanical Life	Times	1×10 ⁶
Electrical Life	Times	6×10 ⁴
Weight	kg	10
Control Power Voltage	V(AC)	110、220
Pick-up Power	W(transient)	400
Hold Power	W	45
Auxiliary Contact	4 pairs NO, 2 pairs NC	
Auxiliary Contact Capacity	AC-15: Ue:AC380V Ie:0.7A DC-13: Ue:DC220V Ie:0.1A	

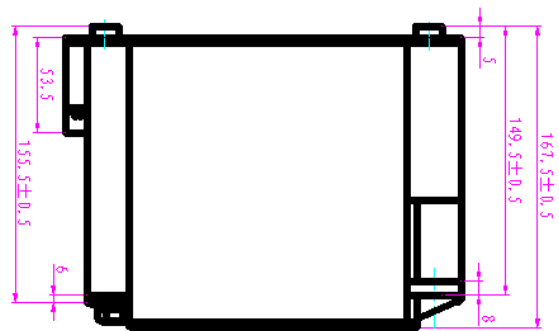

Note: undeclared tolerance dimensions are according with IT13 class