



Data-Sheet-Fixed Vacuum Capacitor



www.glvac.com

| MODEL NUMBER | CAPACITY (pF) | PEAK TEST VOLTAGE (KV) | RF WORKING VOLT.(KV) | AMPS (RMS) MAX. | NOMINAL DIMENSIONS |          |             |          | WEIGHT (NOM.) |
|--------------|---------------|------------------------|----------------------|-----------------|--------------------|----------|-------------|----------|---------------|
|              |               |                        |                      |                 | INCHES             |          | MILLIMETERS |          |               |
|              |               |                        |                      |                 | LENGTH             | DIAMETER | LENGTH      | DIAMETER |               |
| CKT6/25/47   | 6±0.6         | 35                     | 25                   | 47              | 6.44               | 2.32 MAX | 163         | 58.9 MAX | 0.6 Kg        |
| CKT12/25/52  | 12±1.2        | 35                     | 25                   | 52              | 6.44               | 2.32 MAX | 163         | 58.9 MAX | 0.65 Kg       |
| CKT25/25/67  | 25±2.5        | 35                     | 25                   | 67              | 6.44               | 2.32 MAX | 163         | 58.9 MAX | 0.7 Kg        |
| CKT50/25/77  | 50±5          | 35                     | 25                   | 77              | 6.44               | 2.32 MAX | 163         | 58.9 MAX | 0.75 Kg       |
| CKT75/25/82  | 75±3.75       | 35                     | 25                   | 82              | 6.44               | 2.32 MAX | 163         | 58.9 MAX | 0.7 Kg        |
| CKT100/25/87 | 100±5         | 35                     | 25                   | 87              | 6.44               | 2.32 MAX | 163         | 58.9 MAX | 0.75 Kg       |

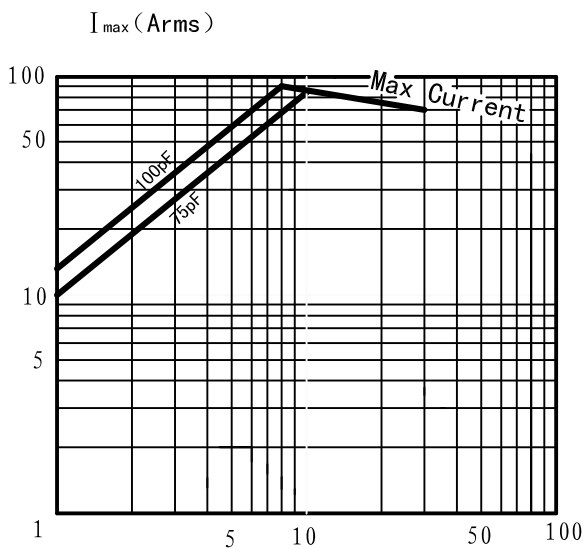
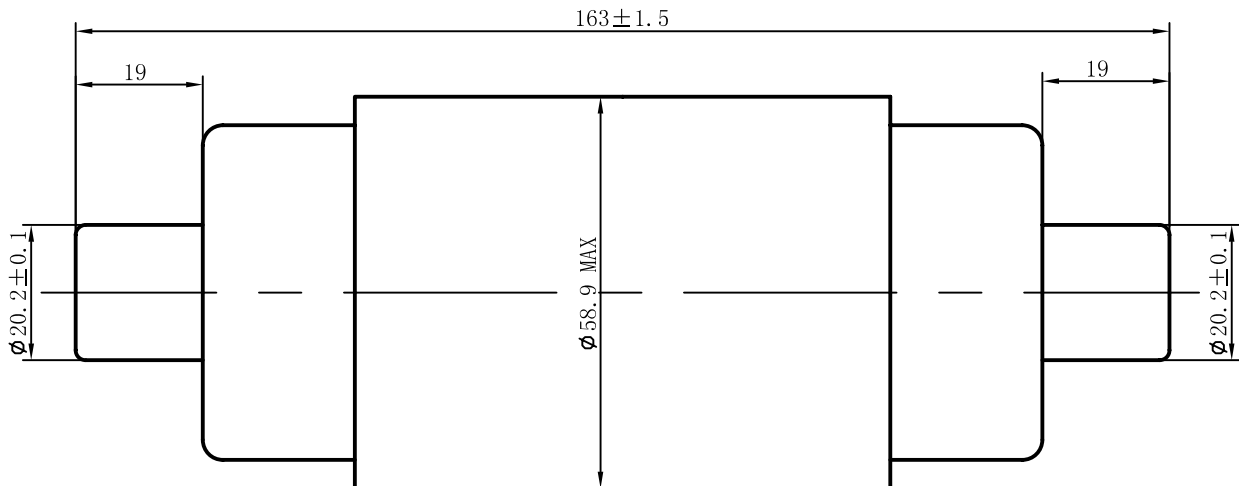

频率曲线 (MHz)  $U_{pw}=25kV$

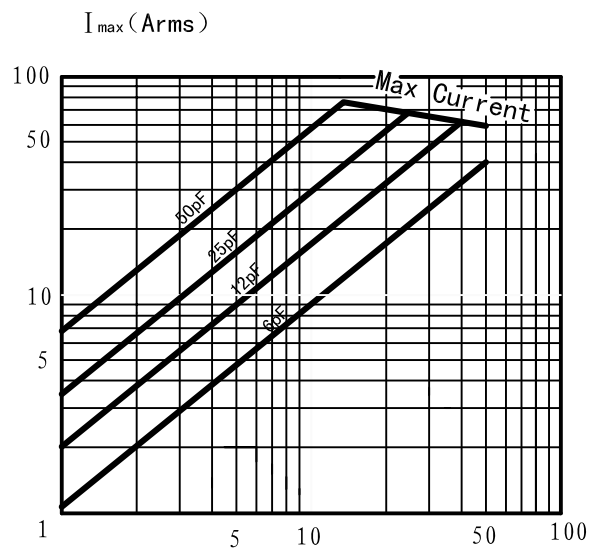

频率曲线 (MHz)  $U_{pw}=25kV$