



Data-Sheet-Fixed Vacuum Capacitor



www.glvac.com

MODEL NUMBER	CAPACITY (pF)	PEAK TEST VOLTAGE (KV)	RF WORKING VOLT.(KV)	AMPS (RMS) MAX.	NOMINAL DIMENSIONS				WEIGHT (NOM.)
					INCHES		MILLIMETERS		
					LENGTH	DIAMETER	LENGTH	DIAMETER	
CKT6/25/47	6±0.6	35	25	47	6.44	2.32 MAX	163	58.9 MAX	0.6 Kg
CKT12/25/52	12±1.2	35	25	52	6.44	2.32 MAX	163	58.9 MAX	0.65 Kg
CKT25/25/67	25±2.5	35	25	67	6.44	2.32 MAX	163	58.9 MAX	0.7 Kg
CKT50/25/77	50±5	35	25	77	6.44	2.32 MAX	163	58.9 MAX	0.75 Kg
CKT75/25/82	75±3.75	35	25	82	6.44	2.32 MAX	163	58.9 MAX	0.7 Kg
CKT100/25/87	100±5	35	25	87	6.44	2.32 MAX	163	58.9 MAX	0.75 Kg

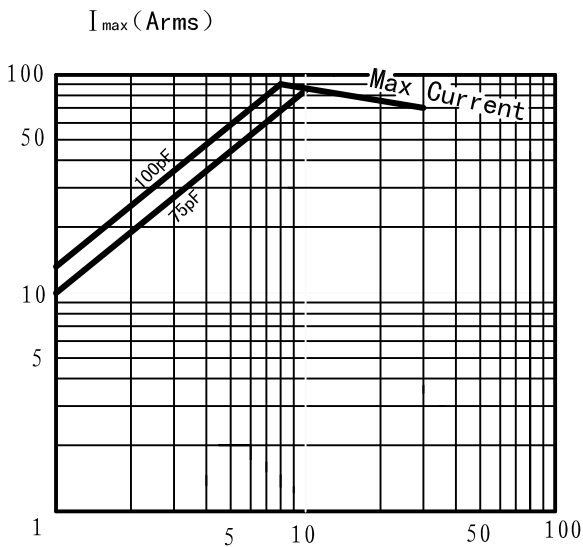
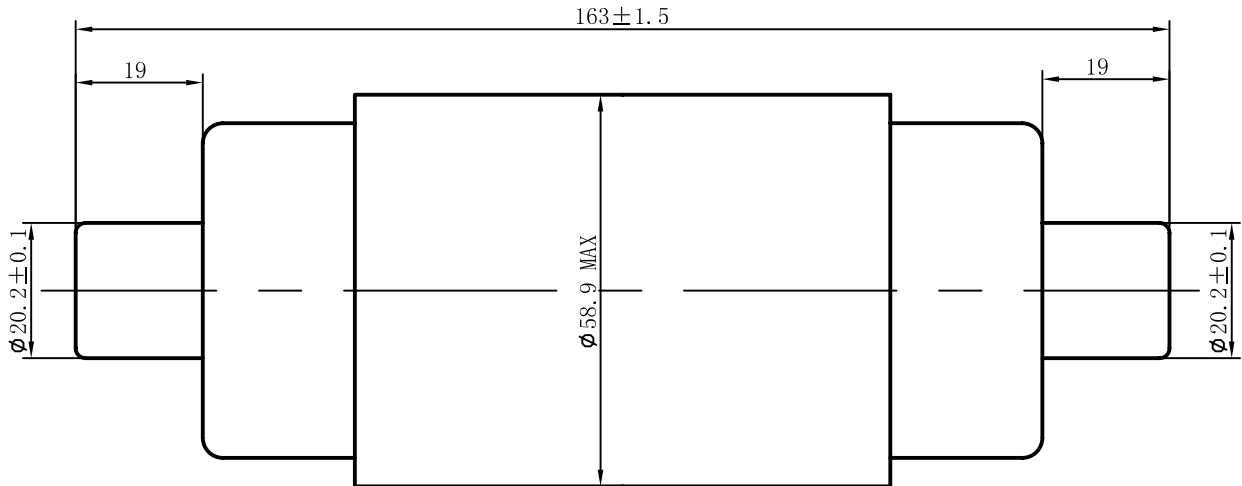

频率曲线 (MHz)  $U_{pw}=25kV$

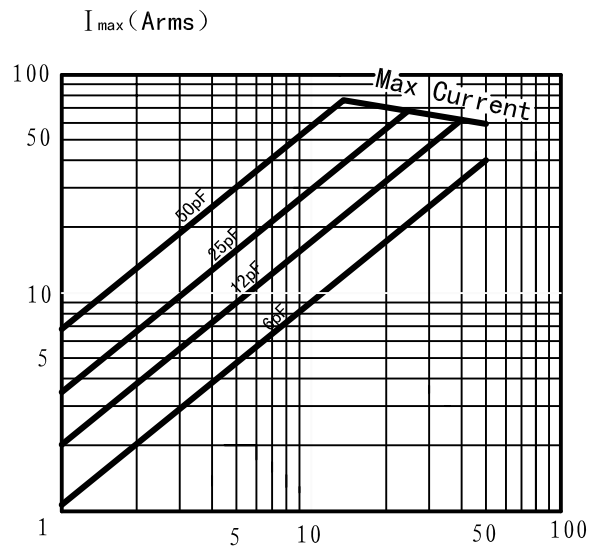

频率曲线 (MHz)  $U_{pw}=25kV$